



ABSTECHSYSTEM 234
ABSTECHEN MIT 2 SCHNEIDEN
BIS DURCHMESSER 65 MM

PARTING OFF SYSTEM 234
PARTING OFF WITH 2 CUTTING EDGES
UP TO A DIAMETER OF 65 MM



DER UNTERSCHIED: MEHR MÖGLICHKEITEN

THE DIFFERENCE:
MORE POSSIBILITIES

- **Abstechplatte mit 2 Schneiden**

Insert with 2 cutting edges

- **Abstechdurchmesser bis 65 mm**

Cutting diameter up to 65 mm

- **2 unterschiedliche Spanform-
geometrien verfügbar**

2 different chip breaking geometries
available

Nummernschlüssel der Klemmhalter

Number code of the toolholder

RH234.2020.33.0A.02.IK

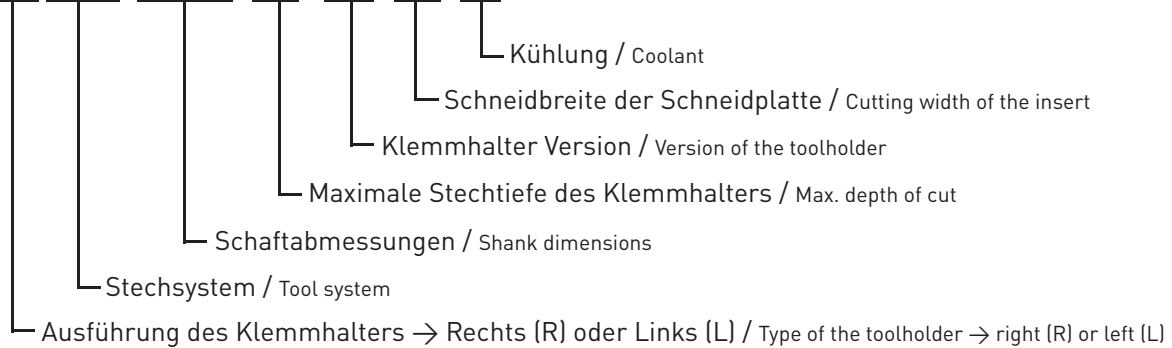

Position der Kühlmittelübergabe

Position of the coolant transfer

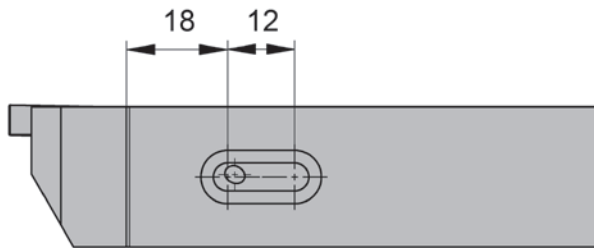

Anzugsmomente

Torque of Screws

Halter Holder	Schraube Screw	M _d Nm
H234...02	6.23T25P	4
H234...03	6.23T25P	6
H234...02.IK	5.13T20P	4
H234...03.IK	5.13T20P	6
NK234...02.IK	5.13T20P	4
NK234...02.IK	5.13T20P	6

Geometrie

Geometry

Werkstoff

Material

Vorschubbereich f [mm/U]

Feed rate f [mm/rev]

Bearbeitung

Machining

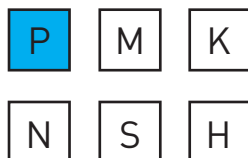

↓
0,10-0,45

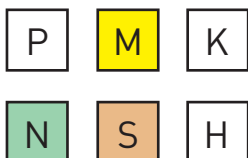
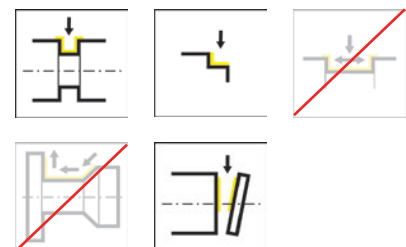

↓
0,05-0,20

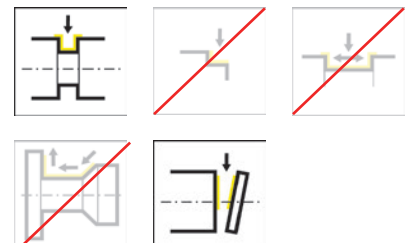

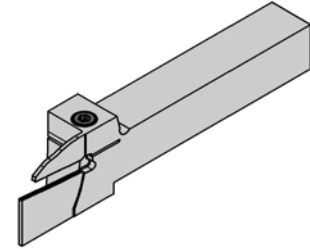
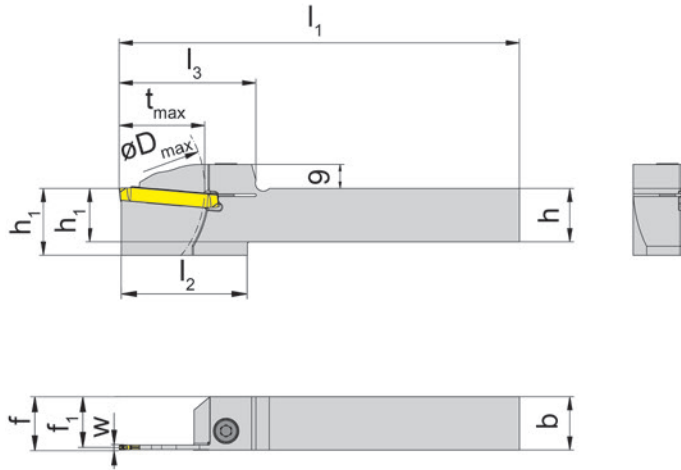
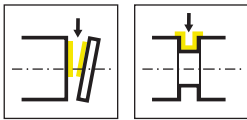

R = rechts wie gezeichnet
R = right hand version shown

L = links spiegelbildlich
L = left hand version

Bestellnummer Part number	h	b	l ₁	l ₂	l ₃	h ₁	f ₁	f	t _{max}	D _{max}	w	HWS
RH234.2020.33.02	20	20	150	48	52	20	19	f ₁ +w/2	33	80	2	23401
RH234.2020.33.03	20	20	150	48	52	20	18,5	f ₁ +w/2	33	80	3	23403
RH234.2525.33.02	25	25	150	48	52	25	24	f ₁ +w/2	33	80	2	23401
RH234.2525.33.03	25	25	150	48	52	25	23,5	f ₁ +w/2	33	80	3	23403
LH234.2020.33.02	20	20	150	48	52	20	19	f ₁ +w/2	33	80	2	23401
LH234.2020.33.03	20	20	150	48	52	20	18,5	f ₁ +w/2	33	80	3	23403
LH234.2525.33.02	25	25	150	48	52	25	24	f ₁ +w/2	33	80	2	23401
LH234.2525.33.03	25	25	150	48	52	25	23,5	f ₁ +w/2	33	80	3	23403

Ersatzteile

Spare Parts

Klemmhalter Toolholder	Spannschraube Clamping Screw	TORX PLUS®-Schlüssel TORX PLUS® Wrench
R/LH234...	6.23T25P	T25PQ

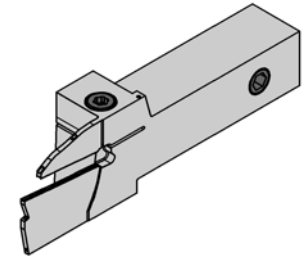
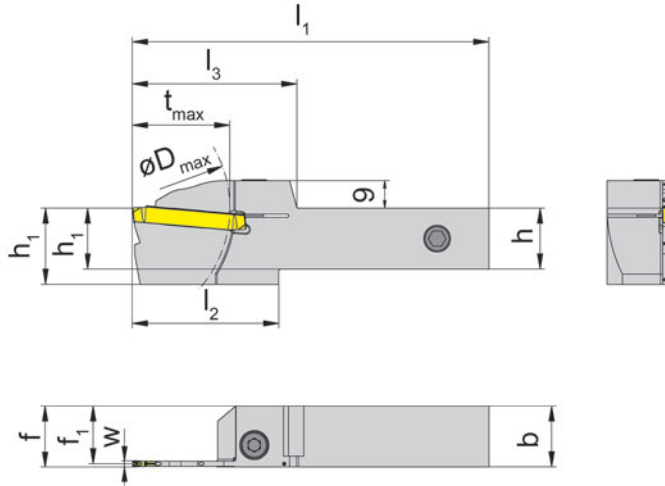
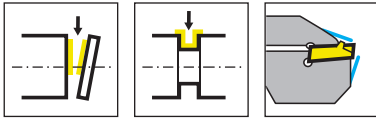

R = rechts wie gezeichnet
R = right hand version shown

L = links spiegelbildlich
L = left hand version

Bestellnummer Part number	h	b	l ₁	l ₂	l ₃	h ₁	f ₁	f	t _{max}	D _{max}	w	HWS
RH234.2020.33.0A.02.IK	20	20	117	48	54	20	19	f ₁ +w/2	33	80	2	23401
RH234.2020.33.0A.03.IK	20	20	117	48	54	20	18,5	f ₁ +w/2	33	80	3	23403
RH234.2525.33.0A.02.IK	25	25	132	48	54	25	24	f ₁ +w/2	33	80	2	23401
RH234.2525.33.0A.03.IK	25	25	132	48	54	25	23,5	f ₁ +w/2	33	80	3	23403
LH234.2020.33.0A.02.IK	20	20	117	48	54	20	19	f ₁ +w/2	33	80	2	23401
LH234.2020.33.0A.03.IK	20	20	117	48	54	20	18,5	f ₁ +w/2	33	80	3	23403
LH234.2525.33.0A.02.IK	25	25	132	48	54	25	24	f ₁ +w/2	33	80	2	23401
LH234.2525.33.0A.03.IK	25	25	132	48	54	25	23,5	f ₁ +w/2	33	80	3	23403

Ersatzteile
Spare Parts

Klemmhalter Toolholder	Kühlmittelanschluss Coolant supply	Spannschraube Clamping Screw	TORX PLUS®-Schlüssel TORX PLUS® Wrench
R/LH234...	004.00.16	6.23T25P	T25PQ

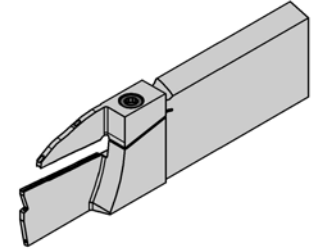
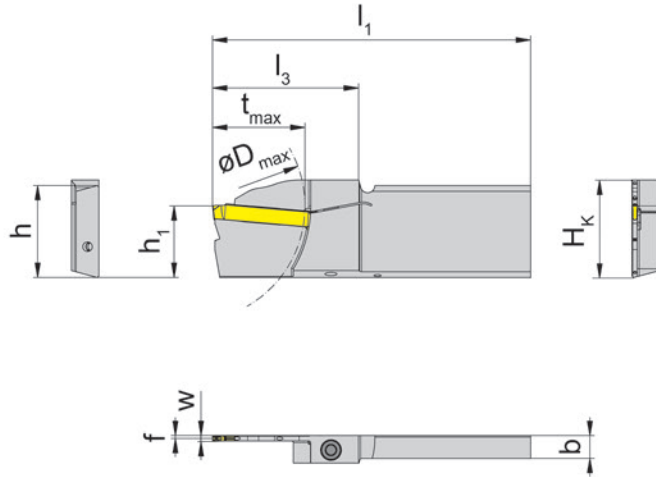
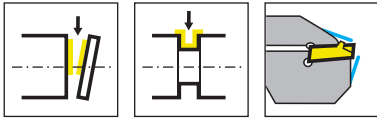

R = rechts wie gezeichnet
R = right hand version shown

L = links spiegelbildlich
L = left hand version

Bestellnummer Part number	H _k	h	l ₁	h ₁	f	l ₃	t _{max}	D _{max}	w	HWS
RH234.3208.33.02.IK	33,8	32	110	24,8	1	51	33	80	2	23401
RH234.3208.33.03.IK	33,8	32	110	24,8	1,5	51	33	80	3	23403
LH234.3208.33.02.IK	33,8	32	110	24,8	1	51	33	80	2	23401
LH234.3208.33.03.IK	33,8	32	110	24,8	1,5	51	33	80	3	23403

Ersatzteile
Spare Parts

Klemmhalter Toolholder	Spannschraube Clamping Screw	TORX PLUS®-Schlüssel TORX PLUS® Wrench
R/LH234...	5.13T20P	T20PQ

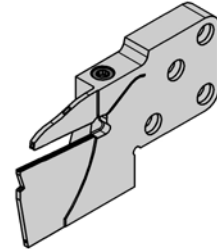
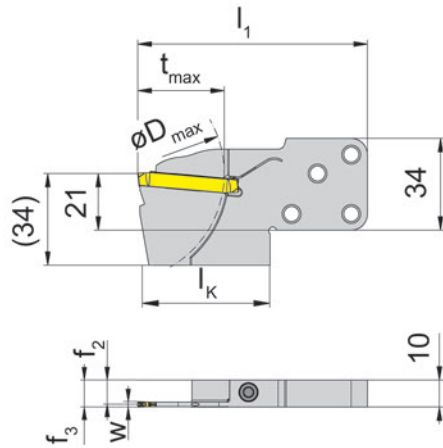
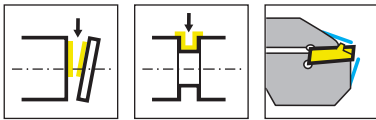

R = rechts wie gezeichnet
R = right hand version shown

L = links spiegelbildlich
L = left hand version

Bestellnummer Part number	t_{max}	f_2	f_3	w	D_{max}	l_1	l_K	HWS	HMS
RNK234.0842.33.4.02.IK	33	9	$f_2+w/2$	2	80	85	49	23401	842002 • 842001
RNK234.0842.33.4.03.IK	33	8,5	$f_2+w/2$	3	80	85	49	23403	842002 • 842001
LNK234.0842.33.4.02.IK	33	9	$f_2+w/2$	2	80	85	49	23401	842002 • 842001
LNK234.0842.33.4.03.IK	33	8,5	$f_2+w/2$	3	80	85	49	23403	842002 • 842001

Ersatzteile
Spare Parts

Kassette Cassette	Spannschraube Clamping Screw	TORX PLUS®-Schlüssel TORX PLUS® Wrench
R/LH234...	5.13T20P	T20PQ

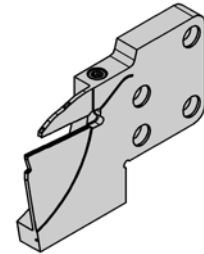
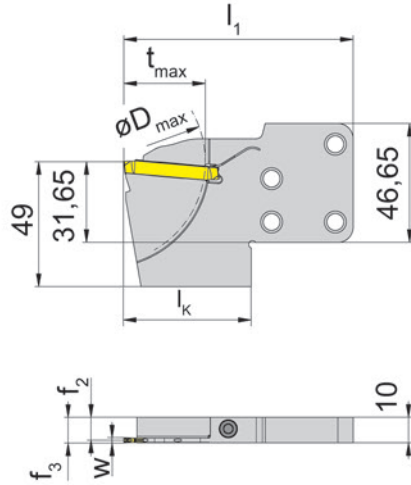
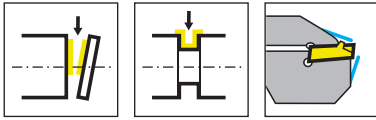

R = rechts wie gezeichnet
R = right hand version shown

L = links spiegelbildlich
L = left hand version

Bestellnummer Part number	t_{max}	f_2	f_3	w	D_{max}	l_1	l_K	HWS	HMS
RNK234.0845.33.4.02.IK	33	9	$f_2+w/2$	2	80	90	50	23401	845002 • 845001
RNK234.0845.33.4.03.IK	33	8,5	$f_2+w/2$	3	80	90	50	23403	845002 • 845001
LNK234.0845.33.4.02.IK	33	9	$f_2+w/2$	2	80	90	50	23401	845002 • 845001
LNK234.0845.33.4.03.IK	33	8,5	$f_2+w/2$	3	80	90	50	23403	845002 • 845001

Ersatzteile
Spare Parts

Kassette Cassette	Spannschraube Clamping Screw	TORX PLUS®-Schlüssel TORX PLUS® Wrench
R/LH234...	5.13T20P	T20PQ

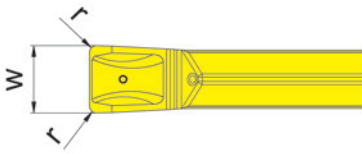
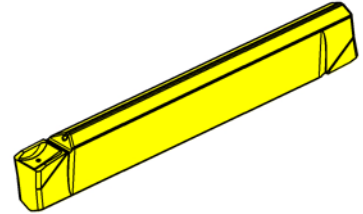
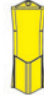
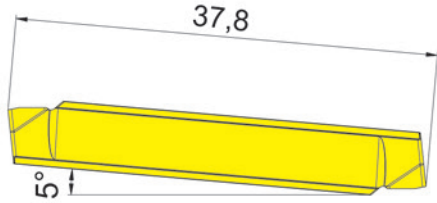
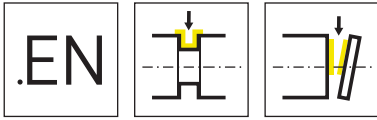

HM-Sorten
Carbide grades

▲ ab Lager
on stock

△ 4 Wochen
4 weeks

Bestellnummer Part number	w	r	HIS	HM-Sorten Carbide grades	
				AS65	IG65
S234.0200.EN2	2	0,2	23401	▲	▲
S234.0300.EN3	3	0,3	23403	▲	▲
				P ● ●	
				M ○ ●	
				K ○ -	
				N - -	
				S - ○	
				H - -	

Wendeschnidplatte

Indexable insert

S234

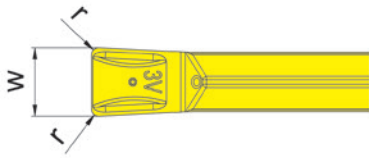
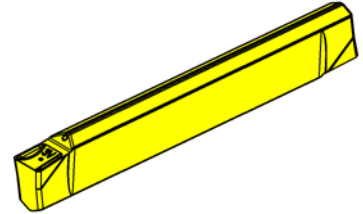
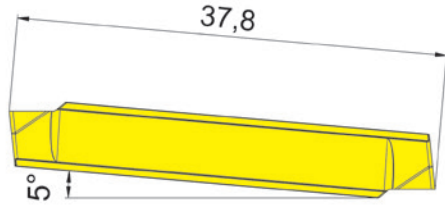
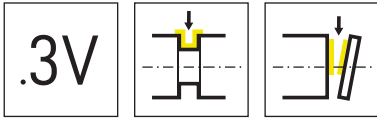

HM-Sorten
Carbide grades

▲ ab Lager
on stock

△ 4 Wochen
4 weeks

Bestellnummer Part number	w	r	HIS	HM-Sorten Carbide grades	
				AS65	IG65
S234.0200.3V2	2	0,2	23401	▲	▲
S234.0300.3V3	3	0,3	23403	▲	▲
				P ●	●
				M ○	●
				K ○	-
				N -	-
				S -	○
				H -	-



**FINDEN SIE JETZT IHRE
PASSENDE WERKZEUGLÖSUNG.**

FIND YOUR RIGHT
TOOLING SOLUTION NOW.

horn-group.com

DEUTSCHLAND, STAMMSITZ

GERMANY, HEADQUARTERS

—

Hartmetall-Werkzeugfabrik
Paul Horn GmbH
Horn-Straße 1
72072 Tübingen

Tel +49 7071 / 7004-0

Fax +49 7071 / 72893

info@de.horn-group.com

horn-group.com