

**SUHNER**  
ABRASIVE



# ROTOmax 4.0

Product Presentation

## ROTOmax 4.0 – at a glance



- Power output: 3.5 kW (until now 3.0 kW)
  - A noticeable higher traction and a more stable rotation speed
  - Very convenient for heavy duty work
- Strong torque → big traction
  - With 10Nm (=100%) operating grad of torque of the NA15
- Wide speed range: 500 – 10'000 rpm
- One motor for “all” voltage ranges for worldwide use
  - 3 x 400 V ... 3 x 480 V
- State-of-the-Art synchronous motor with permanent magnet
  - High efficiency factor (> 90%)
  - Excellent energy efficiency
- With integrated frequency converter
- Wight: approx. **35 kg**
- Turning range in the lift fork
  - 360° horizontal
  - ↑ + 30° / ↓ - 45°

# ROTOmax 4.0 – our versions

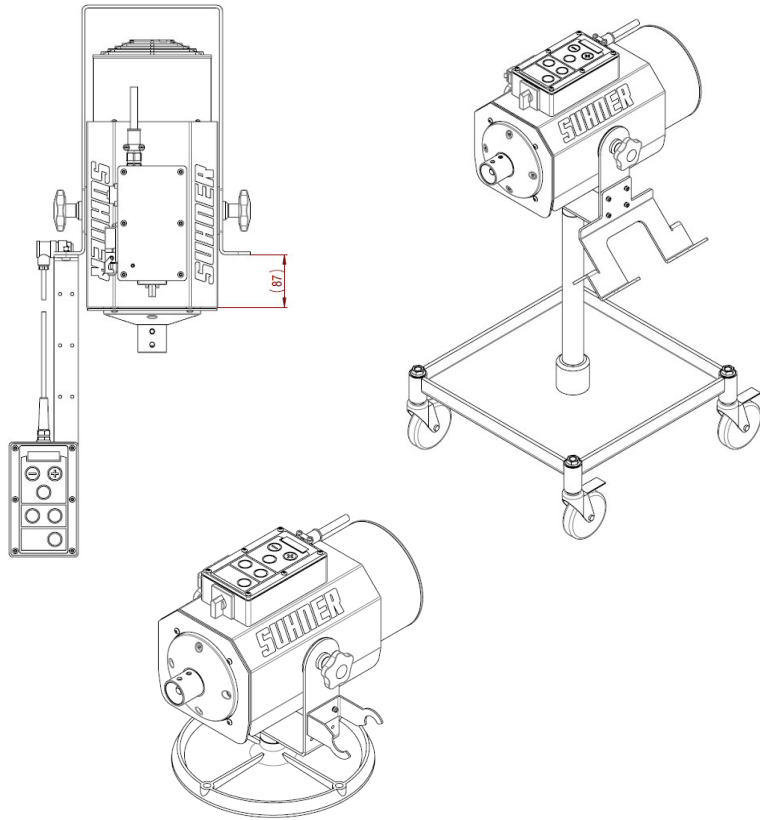

- Easy handling thanks to a compact construction
- Flexible, efficient use and ideal adaptation to the required work processes because of the 3 available models:
  - F with base plate
  - STM trolley mounted
  - HM with hanging attachment

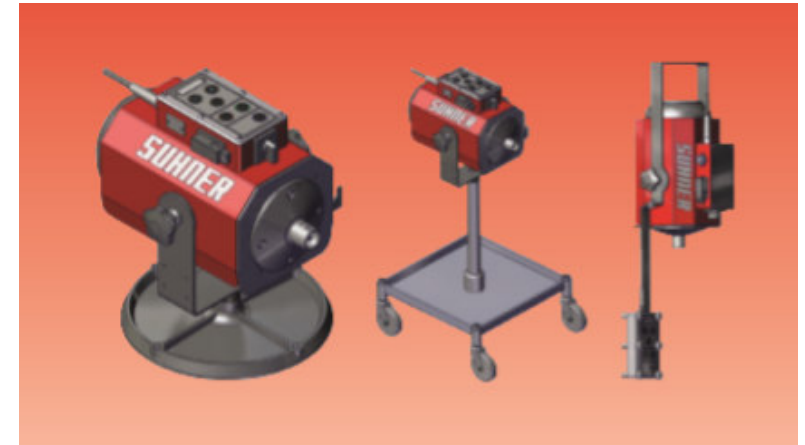

Versions and accessories  
identical to ROTOmax 2.0

# ROTOmax 4.0

## User-friendly and easy handling



- Clear LED display for a good visibility of the rotational speed
- Defined pressure point on the keypad, making it simple to adjust the desired data/speed
- Easy and clear button symbols, which are visible even in an darkened environment
- Accurate start of the working process thanks to the ability to preselect of the required speed
- Manual adjustment of the speed through simple one button pressure in steps of one hundred RPM
- Robust main switch, positioned on the operator's side for easy access

# ROTOmax 4.0

## Very easy to maintain

- Power unit and control box are completely separated from each other: By this way it is assured that the electronics assembly and the electrical components are protected from dust infiltration.
- The three-phase main switch separate and independent and can be replaced easily in case of breakdown.
- The supply cable is connected directly to the control box and can be replaced easily if damaged. No dismantling of the power unit needed!
- The Separate positioning of the control box and the open design enables a simple air-cleaning of the power unit and housing.
- Therefore a longer life-span and lower down time is achieved



# ROTOmax 4.0 (1) external control elements – identical to ROTOmax 2.0



Foot switch 2/4 R + 2/4T

- Foot switch available in 2 variations:
  - As an ON / OFF switch (R)
  - As a 'Dead-Man' Switch (T)

Machine is working as long as the foot switch is held down. Once the pressure of the foot switch is released – the motor stops and the machine will need to be re-set.

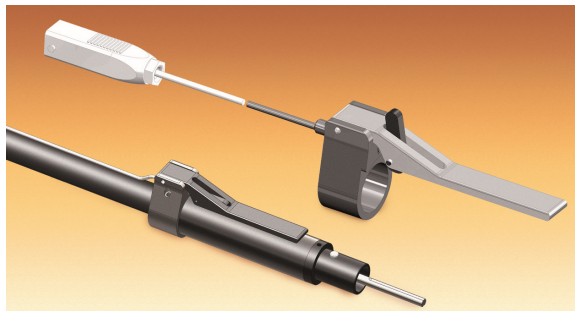

STEP 2/4 / SDC 2/4

- Hand Switch attached to the hand piece (Step/SDC):
  - ON / OFF switch directly on the hand piece, hence «stand-by mode»
  - No unintentional switching-on of the machine thanks to a switch lock sensing device

Machine is working as long as the hand switch is being pressed. Autonomous stopping of the power supply ('Dead Man switch'): After letting go of the switching system the machine turns off

**The external operating elements from the ROTOmax 3.5 series are not compatible with the ROTOmax 4.0 operating elements. Demands a cable / connector with 3-pin and offers therefore a higher level of safety.**



# ROTOmax 4.0 (2)

## external control elements – identical to ROTOmax 2.0



Foot switch 2/4 R + 2/4T

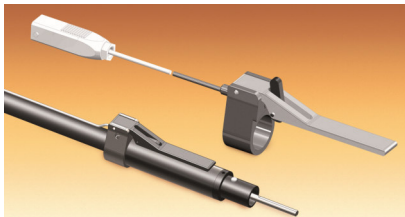

STEP 2/4 / SDC 2/4

For ROTOmax 2.0 / 4.0 only the following products are suitable:

Item No.	Description
110 266 01	Fusschalter 2/4 R
110 267 01	Fusschalter 2/4 T
110 268 01	STEP 2/4 G 28
110 269 01	STEP 2/4 G 35
110 270 01	SDC 2 DIN 10/G 28
110 271 01	SDC 4 DIN 15/G 28
110 272 01	SDC 4 DIN 15/G 35

# ROTOmax 4.0

## Comfortable working at a high level

- Very stable revolution speed
  - Synchronous motor with permanent magnet
  - Revolution speed monitoring and electronic regulation
- Even surface patterns through extremely stable revolution speed
- Exact speed adjustment in steps of hundred RPM's:
  - Ideal cutting / grinding speed is controlled and stabilised
  - Uniform finished surface – higher job performance – better quality
- An integrated frequency converter enables a slow start and smooth acceleration of the speed without vibration of the shaft - No chance of the shaft being jolted out of the user's hand!
- An active and controlled deceleration of the drive motor saves time between work processes and contributes to overall operational safety.
  - Deceleration approx. 8 sec. (with SAM 1:1 ø230 mm)



# ROTOmax 4.0

## ideal safety

- After a power failure, self starting is prevented.
- The overload protection is a motor protection measurement, which prevents components of the motor from overheating and allows efficient, economical operation.
- After adjusting the speed a time limit of 60 seconds is defined before the ROTOmax 2.0 is started. If this time is exceeded, the machine will be put on hold. This function prevents an accidental start.
- At too-high loading on the shaft, caused during a grinding process, the revolution speed will be lowered, in order to deliver more torque and to protect the machine and operator. In an extreme cases the machine will stop. (Caution with NA 4 und NA 7 shafts: They can be sheared due to the high torque.)
- Increased safety thanks to a tangible, defined pressure point on keypad buttons.

# ROTOmax 4.0 is reaching a long working life span

- Driven by a „state of the art“ synchronous motor with a permanent magnet
  - Brushless
  - Almost no heat development due to an effective cooling of the aluminium cooling web
- An open design between housing and power unit prevents heat accumulation, which is positively influencing the life span, besides giving a high continuous rating.
- The smooth start-up preserves - besides the supply grid and the main switch - the flexible shaft and the hand pieces; prolonging the life span of all the components.

## ROTOmax 4.0 – storage place for toolholders

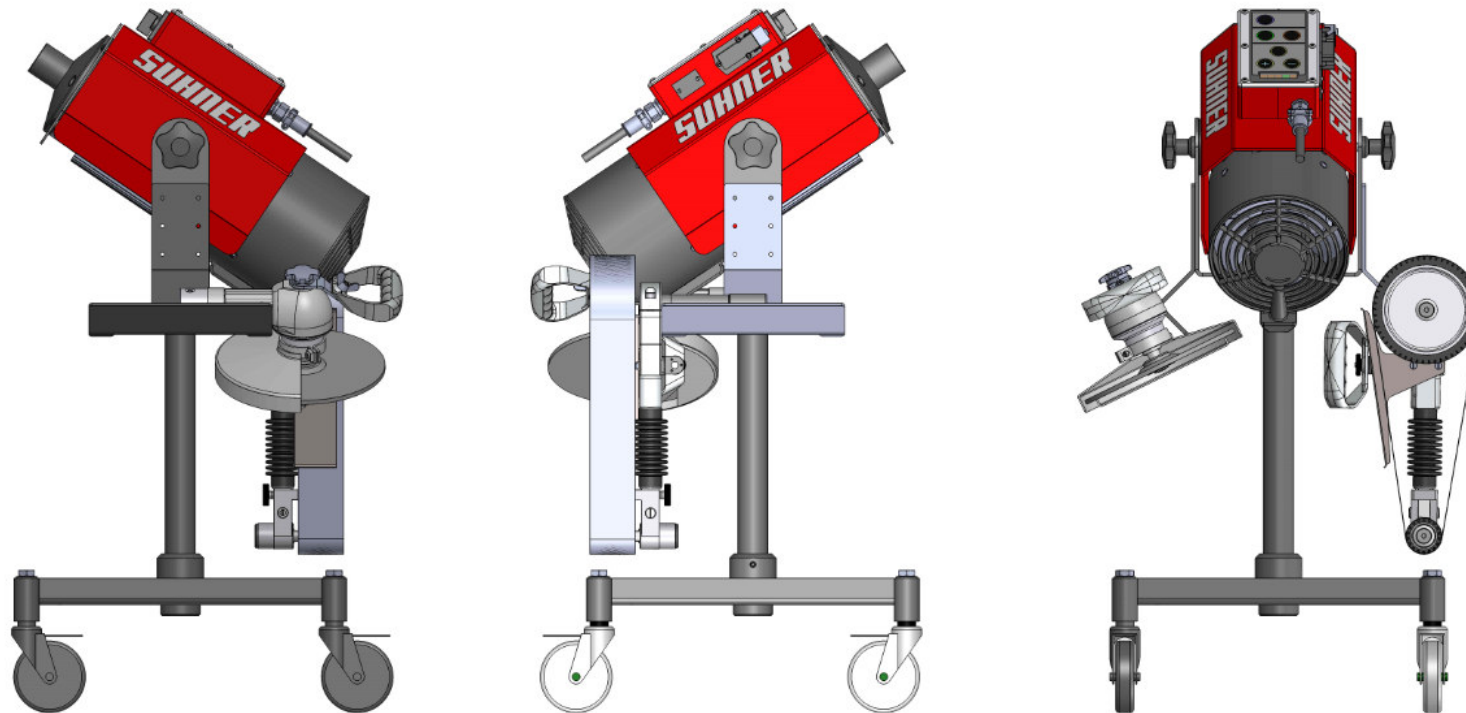

# ROTOmax 4.0 – with base plate

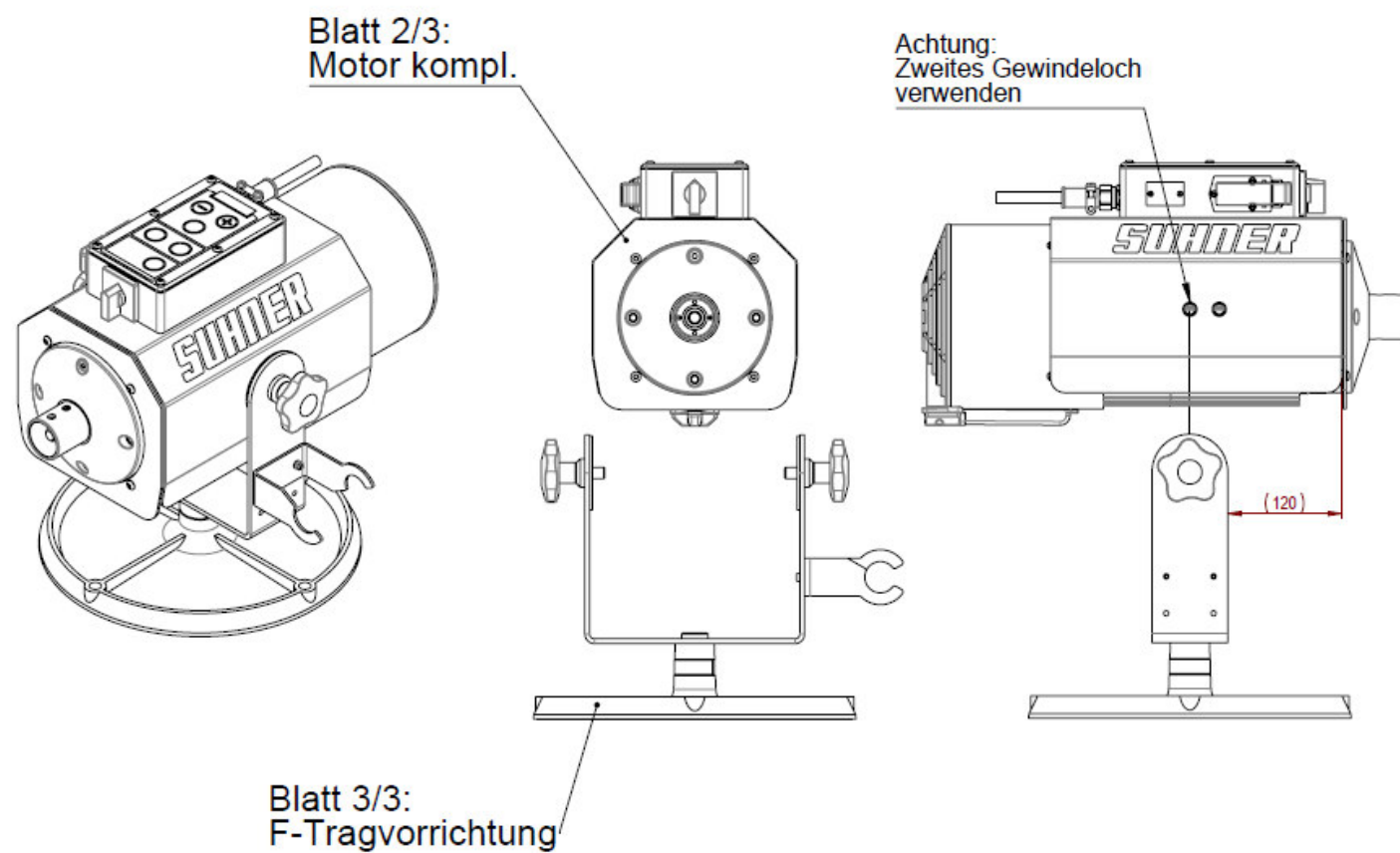

# ROTOmax 4.0 – with hanging attachment

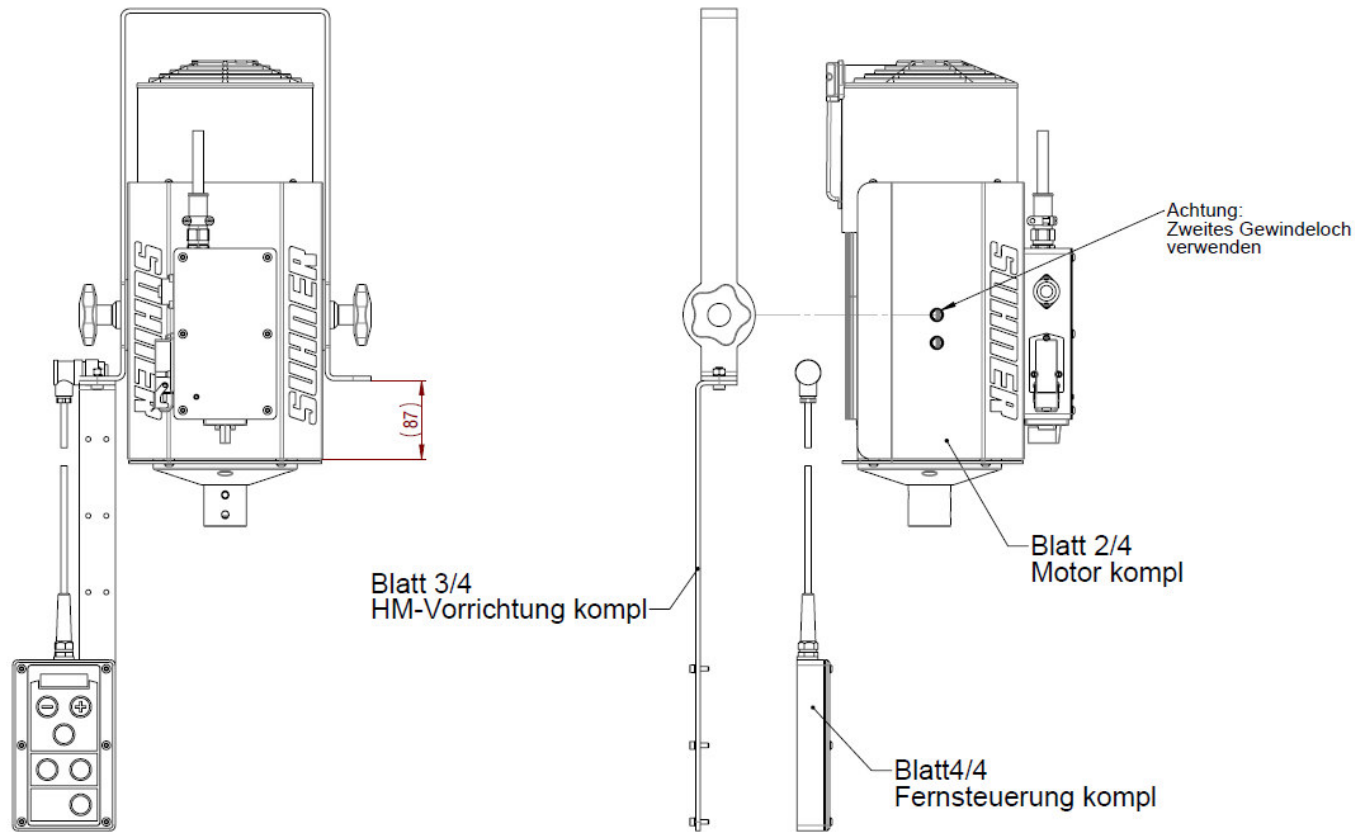

# ROTOmax 4.0 – trolley mounted

